



#5189

Alante



Serial #: 1UJMJABR9M1AV4092
Model: 31V ALANTE MHA
VIN#: 1F65F5DN9LOA18110
Model Year: 2021 Dealer Name: NATIONAL INDOOR RV CENTERS
11280 N SOLAR CONYON WAY
SURPRISE, AZ 85379
USA

Standard Equipment

THE FOLLOWING ITEMS ARE STANDARD ON THIS MODEL
AT NO EXTRA CHARGE

- Exterior
 - Blackout night roller shades
 - Ford® F53 chassis
 - 7.3L V-8 350 HP engine with 468 ft.-lb. torque
 - 6-speed automatic TorqShift® transmission with overdrive and tow haul mode
 - 210-amp alternator
 - G-rated highway tires-245/70R19.5
 - Front and rear disc, 4-wheel anti-lock brakes
 - 5,000 lb. rear hitch receiver with dual connector and 7-pin plug
 - 12V chassis battery
 - 80 gal. fuel tank
 - 120 in. panoramic windshield
 - Stronghold® VBL™ Vacuum-Bond laminated roof, floor and sidewalls
 - Bead-foam insulation (R-24 max roof, R-9 max floor, R-5 max walls)
 - Fiberglass exterior with vinyl graphics
 - Seamless, one-piece fiberglass front cap
 - Entrance door with industry's largest travel view window
 - Electric-powered entrance step
 - Flush-mount LED marker lights
 - Third brake light
 - Lockable pass-through storage compartments with slam latches
 - 30-amp electrical service
 - Frameless windows
 - Onan® Marquis Gold GenSet 4,000-watt generator
 - 12V house battery
 - 16.5 gal. propane tank (56 lb.)
 - LP quick-connect hookup
 - Outside shower
 - Automatic hydraulic leveling jacks
 - 4 in. tube bumper with sewer hose storage
 - Exterior utility center
 - Winterization drain system
 - Solar prep
 - Porch light

- Interior
 - 6-way power driver seat
 - Swivel driver and passenger seats
 - Soft-touch, vinyl wrapped automotive dash
 - Tilt steering wheel
 - A/C and cruise control
 - 94 in. interior ceiling height
 - LED-lit hardwood fascia
 - Ball-bearing drawer guides
 - Hardwood cabinet doors and drawers
 - 8 cu. ft. flush-mount, double door refrigerator
 - Furrion® all-in-one cooktop and oven
 - Residential-sized microwave
 - Large stainless steel kitchen sink with cover
 - LED-lit pressed countertops
 - Flip-up countertop extension (select models)
 - Decorative kitchen backsplash
 - Pop up charging station in kitchen with 110 outlets and USB ports
 - 12V demand water pump
 - Digital antenna with signal booster
 - (2)11,000 BTU A/C units with power management system
 - (15,000 BTU A/C unit with power management system on 26X)
 - 30,000-BTU auto-ignition ducted furnace
 - Water filtration system
 - Jayco-exclusive easy operation legless dinette table
 - 2-point lap safety belts in all designated seating locations
 - High-intensity recessed LED ceiling lights
 - Power front privacy shade with manual side privacy shades
 - Blu-Ray™ player in living area
 - Digital antenna with signal booster
 - Cable TV hookup with RG6 coax and video selector switch
 - Stainless steel bathroom sink
 - Toilet with foot flush
 - Shower with decorative surround, glass door, skylight and light
 - Powered roof vent in bathroom with wall switch
 - Walk-around Queen-sized bed with bedspread and nightstands (King-sized in 27A)
 - Powered roof vent in bedroom with wall switch (26X)
 - Under-bed storage (select models)
 - Bunks with industry-exclusive 300 lb. capacity each (29F)
 - Smoke alarm
 - Carbon monoxide detector

- Customer Value Package
 - JRD® Computer-balanced driveshaft, Jounce bumpers, heavy-duty front and rear stabilizer bars, SACHS shocks
 - Sony® infotainment center Apple CarPlay® and Android Auto™
 - One-piece seamless crowned fiberglass roof
 - Backup and side-view cameras
 - 1,000-watt inverter
 - Electric patio awning with LED lights
 - Exterior entertainment center with outside speakers, LED TV mounted on swivel bracket and single-disc DVD/MP3 radio
 - LED living room TV
 - Removable driver/passenger cockpit table

Optional Equipment

OPTIONAL EQUIPMENT INSTALLED ON THIS VEHICLE
BY MANUFACTURER

Base price	129,368.00
Modern Farmhouse	443.00
USA Standards	n/c
Customer Value Package	9,923.00
Bedroom TV	383.00
8 Cu. Ft. Refrigerator	n/c
Standard House Battery	n/c
Theater Seating Sofa	375.00
Front Overhead Bunk	2,243.00

UNIT TOTAL

142,735.00

DEALER INSTALLED OPTIONS:

Manufacturer's Suggested Retail Price \$142,735.00

TOTAL AMOUNT DOES NOT INCLUDE STATE AND LOCAL TAXES OR LICENSE FEES. THE PRICE SHOWN ABOVE MAY OR MAY NOT BE REPRESENTATIVE OF THE ACTUAL SELLING PRICE OF SIMILAR RECREATIONAL VEHICLES IN YOUR AREA.

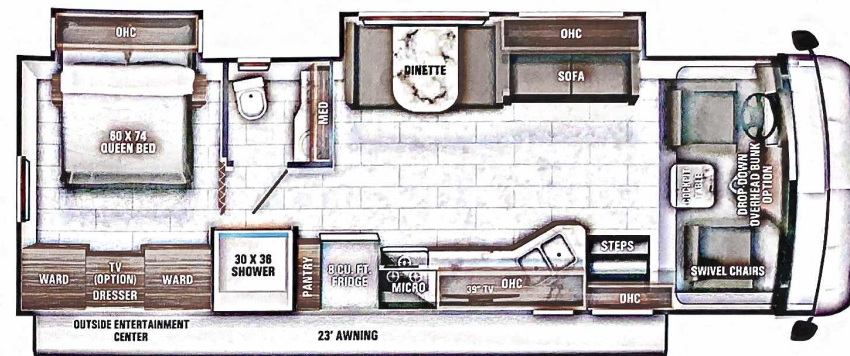

DIMENSIONS

Exterior height:.....149.00"
Exterior width:.....101.00"

CAPACITIES

Fresh water tank (gals.):...72.00
Gray water tank (gals.):...40.00
Black water/toilet tank (gals.):...50.00
Propane (lbs.):...56
Propane (gals.):...13
Water heater (gals.):...6.00

TIRES

Tire size (front):.....245/70R19.5G
Tire size (mid):.....
Tire size (rear):.....245/70R19.5G

Some dimensions may be rounded and may vary from the actual dimensions
***Weights may be estimated calculations and may vary from the actual weight
- refer to the vehicle weight labels for actual weights***
Floorplans, features and specifications are subject to change without notice.

2+3
YEAR LIMITED STRUCTURAL WARRANTY