



ENTEGRA

COACH®

Accolade XT



Serial #: 1J5NCEBR9R1J08081
 Model: 32U ACCOLADE XT MHC
 VIN#: 1FDJFF6L1T9PDA05777
 Model Year: 2024 Dealer Name: NATIONAL INDOOR RV CENTERS
 4640 NEXUS WAY
 NORTH LAS VEGAS, NV 89115

Standard Equipment

THE FOLLOWING ITEMS ARE STANDARD ON THIS MODEL AT NO EXTRA CHARGE

- STANDARD EXTERIOR EQUIPMENT**
- For® F50 4x4 chassis (297)
 - For® F60 4x4 chassis (32U, 35L)
 - GVWR - 3,500 lb (297), 22,000 lb (32U, 35L)
 - GVW - 3,100 lb (297), 18,000 lb (32U, 35L)
 - 6.7L Power Stroke V8 Turbo diesel engine with block heater, 300 HP at 2,200 RPM and 950 lb ft torque at 1,800 RPM
 - 332 amp alternator (dual)
 - All terrain tires - 245/70R19.5
 - H-Spec male black aluminum urea
 - 12,000 lb. hitch receiver and 7-pin plug
 - For® Advantec® TACO with RSOC® (oil stability control) and trailer sway control
 - 120 amp battery (750 CCA, 78 AH)
 - Dual fuel tanks (26.5 gal. and 40 gal.)
 - TuffShell™ vacuum bond laminated roof, floor and sidewall
 - TuffShell™ vacuum bond laminated roof, floor and sidewall insulation (R-24 max roof, R-9 max floor, R-8 max walls)
 - One piece, seamless, covered fiberglass roof
 - Premium Sakens® full body paint
 - 100% vinyl floor
 - Electric powered entrance steps
 - Slideout cover awnings
 - Exterior entertainment center with outside speakers.
 - 120V AC power outlets
 - W/ingard® in-motion satellite dish
 - Full pass through storage compartments with lockable slam latch doors
 - Third brake light
 - KING Jack™ antenna
 - Roof ladder
 - Onan® 6,000W Quiet Diesel generator and auto gen start
 - (2) 6V AGM house batteries
 - 5-pin trailer connector
 - Reverse switch with reverse polarity protection
 - 24.5 gal propane tank (63 b)
 - LP quick-connect hookup
 - Exterior utility center
 - 12V DC power outlets
 - Black tank flush
 - Outside shower
 - 12V demand water pump
- CUSTOMER VALUE PACKAGE**
- E-Z Drive™ Premier™ Computer balanced driveshaft, heavy-duty front and rear stabilizer bars, Helwig® heavy-duty shocks
 - One piece, seamless, fiberglass front cap with auxiliary flood lights
 - One piece, seamless, fiberglass rear cap with auxiliary flood lights (32U, 35L)
 - 15,000 BTU A/C unit with heat pump and second with power shade
 - 13,500 BTU A/C unit with heating, legless patio awning with LED lights
 - 2,000W pure sine wave inverter
 - 200V 20A panel with dual controller
 - Backup and side-view camera
 - Two burner induction cooktop
 - 110 or 112V refrigerator (297)
 - 110 or 112V refrigerator (32U, 35L)
 - Convection microwave oven

Optional Equipment

OPTIONAL EQUIPMENT INSTALLED ON THIS VEHICLE BY MANUFACTURER

- STANDARD INTERIOR EQUIPMENT**
- Audio area departure warning
 - Pre-collision Assist with automatic emergency braking
 - SOS Post-Crash Alert System™
 - Driver and passenger airbags
 - Safety Canopy® system with roll-over side-curtain airbags
 - SecuLock® anti-theft system
 - Quad dual-beam halogen headlights
 - Ramming wiper activated headlights
 - Adjustable gasbrake pedals
 - Individual tire pressure monitoring system (TPMS)
 - Cruise control
 - Power windows and door locks
 - 8-way power driver seat
 - Tilt steering wheel
 - Custom-molded ABS surround in cab-over area
 - Frilly Multiplex system™ - wall-mounted touchscreen and mobile app for total coach control
 - 84 in. interior ceiling height with padded vinyl ceiling
 - Raised-panel, hardwood cabinet doors and drawer fronts
 - Deluxe hidden cabinet hinges
 - Ball-bearing drawer guides
 - 10 gal. gas/electric water heater
 - 10 gal. gas/electric water heater
 - Entegra-exclusive, easy-operation legless dinette table (32U, 35L)
 - 2-point safety belts in all designated seating locations
 - LED HD Smart TV in living area
 - Smoke alarm
 - Carbon monoxide detector
 - LED-ill. solid surface kitchen countertops with recessed stainless steel sink and sink covers
 - Pull-out countertop extension (select models)
 - (297) Walk-around power sofa convertible to 69 in. x 96 in. bed
 - (32U, 35L) Walk-around, king size bed with bedspread and mattress (32U, 35L)
 - (32U, 35L) Bedroom (32U, 35L)
 - (32U, 35L) Under bed storage (select models)
 - Large wardrobes
 - LED-ill. decorative shower surround with glass door, skylight and light
 - Macaoling porcelain toilet
 - Powered roof vent in bathroom with wall switch

Base price	322,975.00
COLD SPRING	N/A
ARCHADIAN ASH CABINETRY	30.00
DESERT DUNE PAINT PACKAGE	30.00
CSA STANDARDS	N/A
RESIDENTIAL REFRIGERATOR	31,050.00
IN-DOOR DISH SATELLITE SYSTEM	N/A
THEATER SEATING SOFA	N/A
W/POWER	1,125.00

UNIT TOTAL **355,110.00**

DEALER INSTALLED OPTIONS

Manufacturer's Suggested Retail Price \$355,110.00

TOTAL AMOUNT DOES NOT INCLUDE STATE AND LOCAL TAXES OR LICENSE FEES. THE PRICE SHOWN ABOVE MAY OR MAY NOT BE REPRESENTATIVE OF THE ACTUAL SELLING PRICE OF SIMILAR RECREATIONAL VEHICLES IN YOUR AREA.

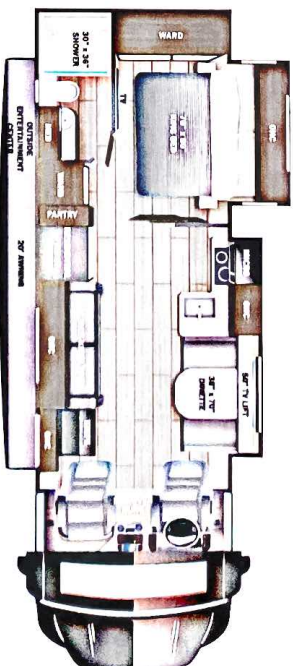

DIMENSIONS

Exterior height: 144.00"
 Exterior width: 101.00"
 Tire size (front): 245 70R19.5S
 Tire size (mid): 245 70R19.5S
 Tire size (rear): 245 70R19.5S

CAPACITIES

Fresh water tank (gals.): 60.00
 Gray water tank (gals.): 38.00
 Black water toilet tank (gals.): 30.00
 Propane (lbs.): 85
 Propane (gals.): 19
 Water heater (gals.): 8.00

TIRES

Tire size (front): 245 70R19.5S
 Tire size (mid): 245 70R19.5S
 Tire size (rear): 245 70R19.5S

Some dimensions may be rounded and may vary from the actual dimensions
 Weights may be estimated calculations and may vary from the actual weights
 - refer to the vehicle weight labels for actual weights***
 Floorplans, features and specifications are subject to change without notice.