



ENTEGRA

COACH®

Odyssey

Serial #: 1J5LECBM3S1EB8051
 Model: 24B ODYSSEY MHC
 VIN#: 1FDXE4FN2SDD00978
 Model Year: 2025 Dealer Name: NATIONAL INDOOR RV CENTERS
 4640 NEXUS WAY
 NORTH LAS VEGAS, NV 89115



Standard Equipment

THE FOLLOWING ITEMS ARE STANDARD ON THIS MODEL AT NO EXTRA CHARGE

- STANDARD EXTERIOR EQUIPMENT**
- Forgo® E-450 chassis
 - GVWR - 14,500 lb
 - GVW - 12,500 lb
 - 7.3L V8 325 HP engine with 450 lb. lb. torque
 - 6-speed TorqShift® series transmission with overdrive
 - Catalytic converter theft deterrent
 - E-rated highway tires - LT225/75R16
 - Pure pressure anti-leak system (PLS)
 - Power windows with auto-up/down
 - 7,500 lb. hitch with 750 lb. tongue capacity and 7-pin plug
 - 65 amp AGM battery
 - TuffShell™ vacuum-bond laminated roof, floor and sidewalls
 - Rear seat headrests (R-24 rear seat, R-9 max)
 - Aluminum turning boards
 - All-terrain tires with vinyl graphics
 - LED interior and exterior lighting
 - Entrance door with industry's largest level-view window
 - Pass-through storage compartment with light
 - Side-out cover awnings
 - House battery compartment
 - Exterior LED HD Smart TV with (2) high-output, marine-grade exterior speakers
 - Third brake light (2BR, 28M, 27U, 29V, 31F)
 - 4-in. bumper tube sewer hose storage
 - Prep for satellite dish
 - Cable TV hookup with RG-6 coax
 - 4,000W generator
 - Solar prep
 - 1,000W inverter
 - Transfer switch with reverse polarity protection
 - 30-amp electrical service
 - 12 gal. propane tank (4 lb)
 - Exterior utility center
 - Winterization drain system
 - Outside shower
 - Water filtration system
 - Water heater pump

- STANDARD INTERIOR EQUIPMENT**
- Sewal driver and passenger seats
 - Remote-controlled slide-view mirrors
 - 12V power outlets
 - Hill start assist
 - Cruise control
 - Electronic stability control
 - Auxiliary start switch
 - Power windows and door locks
 - Power and passenger airbags
 - Remote keyless cab entry
 - Custom-molded ABS surround in cab-over area
 - Overhead bunk with 750 lb. capacity and safety net
 - High-intensity recessed LED lights
 - LED-ill. slide-out fascia
 - Redwood cabinet doors and drawer fronts
 - Interior command center
 - Interior entrance door grab handle
 - Interior entrance door
 - LED interior lighting
 - LED-ill. slide-out shades
 - 12V refrigerator
 - 20,000 BTU auto-ignition furnace
 - Electric fireplace (26M, 30Z)
 - Gas, gas-heated DSI auto-ignition water heater
 - 2-point lap safety belts in all designated seating locations
 - JBL® audio system
 - Smoke alarm
 - Fire extinguisher
 - 10 cu. ft. 12V refrigerator
 - Furnace air-flow hood and oven
 - LED-ill. kitchen counter tops
 - Recessed stainless steel kitchen sink with cutting board sink
 - Recessed stainless steel kitchen sink with cutting board sink
 - Recessed stainless steel bathroom sink
 - Pop-up charging station with 120V outlet and USB plugs
 - Queen-size bed with bedspread (24B, 25R, 29V, 30Z, 31F)
 - On-board power center (26M)
 - USB port and wireless charging in nightstands (27U, 29V, 30Z, 31F)
 - USB port in cabinet over bed (24B, 25R, 28M)
 - Bedroom TV prep
 - Large wardrobes
 - Bunks with industry recliner, 300 lb. capacity each (31F)
 - Shower with decorative surround, glass door, skylight and light
 - Powered roof vent in bathroom with wall switch

Optional Equipment

OPTIONAL EQUIPMENT INSTALLED ON THIS VEHICLE BY MANUFACTURER

- Base price**
- FARMHOUSE
 - GUNNERTAL PARTIAL PAINT
 - USA STANDARDS
 - 25 FD E45 14500 158*
 - 7.3L WHITE SC10
 - CUSTOMER VALUE PACKAGE
 - BEDROOM TV
 - HYDRAULIC AUTO LEVELING
 - JACKS
 - 200W ROOF MOUNTED SOLAR PANEL W/2ND HOUSE BATTERY
 - STANDARD HOUSE BATTERY
 - FOLDING WINDSHIELD SUN SHADE
- | | | | | | | | | | | | |
|------------|--------|----------|-----|-----|----------|--------|----------|--------|-----|--------|-----|
| 159,960.00 | 443.00 | 3,743.00 | n/c | n/c | 6,000.00 | 383.00 | 3,893.00 | 893.00 | n/c | 488.00 | n/c |
|------------|--------|----------|-----|-----|----------|--------|----------|--------|-----|--------|-----|

UNIT TOTAL **175,803.00**

DEALER INSTALLED OPTIONS

Manufacturer's Suggested Retail Price \$175,803.00

TOTAL AMOUNT DOES NOT INCLUDE STATE AND LOCAL TAXES OR LICENSE FEES. THE PRICE SHOWN ABOVE MAY OR MAY NOT BE REPRESENTATIVE OF THE ACTUAL SELLING PRICE OF SIMILAR RECREATIONAL VEHICLES IN YOUR AREA.

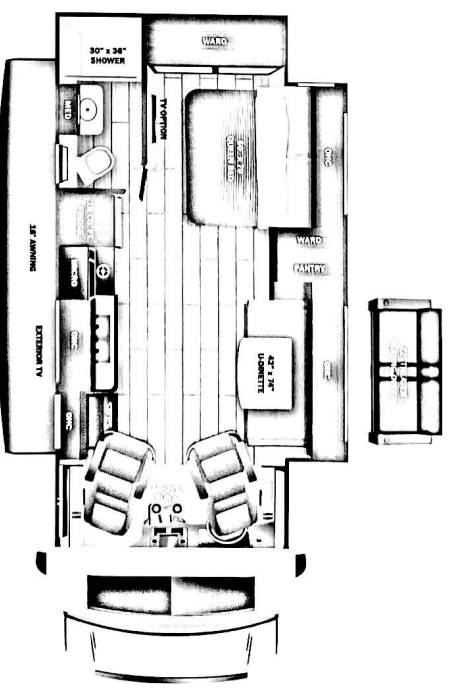

- DIMENSIONS**
- Exterior height: 140.00*
 - Exterior width: 100.00*
- CAPACITIES**
- Fresh water tank (gals.): 42.50
 - Gray water tank (gals.): 40.00
 - Black water/coilet tank (gals.): 31.00
 - Propane (lbs.): 41
 - Propane (gals.): 9
 - Water heater (gals.): 6.00

- TIRES**
- Tire size (front): LT225/75R16
 - Tire size (mid): LT225/75R16
 - Tire size (rear): LT225/75R16

Some dimensions may be rounded and may vary from the actual dimensions
 Weights may be estimated calculations and may vary from the actual weight
 - refer to the vehicle weight labels for actual weights***
 Floorplans, features and specifications are subject to change without notice.