



ENTEGRA

COACH®

SN 11846

Standard Equipment

Serial #: 1J5MEABU6S1UC8062
 Model: 36C VISION XL MHA
 VIN#: 1F66F5DN9R0A00042
 Model Year: 2025 Dealer Name: NATIONAL INDOOR RV CENTERS
 4640 NEXUS WAY
 NORTH LAS VEGAS, NV 89115



Optional Equipment

THE FOLLOWING ITEMS ARE STANDARD ON THIS MODEL AT NO EXTRA CHARGE

OPTIONAL EQUIPMENT INSTALLED ON THIS VEHICLE BY MANUFACTURER

- STANDARD EXTERIOR EQUIPMENT**
- 6000# 553 chassis
 - GVWR - 22,000 lb. (34B, 34G) 24,000 lb. (36A, 36C)
 - CVW - 26,000 lb. (34B, 34G), 30,000 lb. (36A, 36C)
 - 7.3L V-8 335 HP engine with 468 ft.-lb. torque
 - 6-speed automatic TorqShift® transmission with overdrive and low haul mode
 - Catalytic converter theft deterrent
 - G-rated highway tires - 235/60R22.5 (34B, 34G), 255/60R22.5 (36A, 36C)
 - 5.000 lb. rear hitch receiver with dual connector and 7-pin plug
 - 12V chassis battery
 - TuffShell™ vacuum bond laminated roof, floor and sidewalls
 - Braed foam insulation (R-24 max roof, R-9 max floor, R-6 max walls)
 - One-piece seamless fiberglass front cap with partial paint
 - One-piece seamless fiberglass rear cap
 - Fiberglass seamers, including vinyl stripes
 - Enhance door with industry's largest travel-view window
 - Electric-powered entrance steps
 - Metal seam latches
 - Third brake light
 - Electric power door
 - Cable TV hookup with RG-6 coax
 - Wireguard 2.0 Wi-Fi/4G antenna
 - (2) 9V AGM (220Ah) house batteries on slideout tray
 - Transfer switch with reverse polarity protection
 - Diagnostic power cord (56lb)
 - LP quick-connect hookup
 - Heated holding tanks (12V pads)
 - Exterior utility center
 - Sewer pump system
 - Black tank flush
 - Outside shower
 - 12V demand water pump
 - Water filtration system

- STANDARD INTERIOR EQUIPMENT**
- 120 in. panoramic windshield
 - 6-way power and swivel driver/passenger seats
 - Soft-touch, vinyl-wrapped automotive dash
 - Cruise control
 - Hill start assist
 - Electronic stability control
 - Traction control
 - Power front privacy shade with manual side privacy shades
 - Frantly Multiplex system - wall-mounted touchscreen and mobile app for total coach control
 - High-intensity recessed LED ceiling lights
 - LED-ill. fascia
 - Hardwood cabinet doors and drawer fronts
 - 30,000 BTU auto-ignition ducted furnace (34B, 34G, 36C)
 - (2) 30,000 BTU auto-ignition ducted furnaces (36A)
 - Electric fireplace (34B, 34G, 36C)
 - 2-point lap safety belts in all designated seating locations
 - Car seat leathers (select floorplans)
 - J&B® audio system
 - Carbon monoxide detector
 - Fire extinguisher
 - Forward air-flow cooling and oven
 - Decorative vitelium backsplash
 - Walk-around, king-size bed with bedspread and nightstands
 - Under-bed storage (select models)
 - LED HD Smart TV in bedroom
 - Large wardrobes
 - 300 lb. capacity, 300 lb. capacity each (36A)
 - Wall-mounted label holder in each bunk (36A)
 - Shower with decorative surround, glass door, skylight and light
 - Pressed stainless steel bathroom sink
 - Porcelain toilet with foot flush
 - Powered roof vent in bathroom with wall switch
- CUSTOMER VALUE PACKAGE**
- EZ Drive™ Elite: Composite/delaminated drivetrain, Bilstein® steering stabilizer, Konig® shocks, variable-rate front and rear lounge burners, heavy-duty front and rear stabilizer bars, 22.5 in. Michelin tires
 - Lippert™ 4000 series frameless bonded windows
 - 15,000 BTU A/C unit with heat pump and second 13,500 BTU A/C unit
 - LED entertainment center with outside speakers and LED HD Smart TV mounted on swivel bracket
 - Electric patio awning with LED lights
 - 1200W Inverter
 - 50-amp electrical service
 - 10 gal. gas/electric water heater
 - Apple CarPlay™ and Android Auto™
 - Backup and side-view cameras
 - Removable driver/passenger cockpit table
 - LED light, speed sensor kitchen combination with recessed slide
 - LED HD Smart TV in living area
 - Integrated day/night cassette shades

Base price 221,393.00
 FEASIBILITY 443.00
 ICE BLOCK GRAPHICS N/C
 USA STANDARDS N/C
 CUSTOMER VALUE PACKAGE 11,250.00
 RESIDENTIAL REFRIGERATOR N/C
 NO WASHBOARDRY N/C
 FRONT OVERHEAD BUNK 3,293.00

DEALER INSTALLED OPTIONS:

UNIT TOTAL **236,379.00**

Manufacturer's Suggested Retail Price \$236,379.00

TOTAL AMOUNT DOES NOT INCLUDE STATE AND LOCAL TAXES OR LICENSE FEES. THE PRICE SHOWN ABOVE MAY OR MAY NOT BE REPRESENTATIVE OF THE ACTUAL SELLING PRICE OF SIMILAR RECREATIONAL VEHICLES IN YOUR AREA.

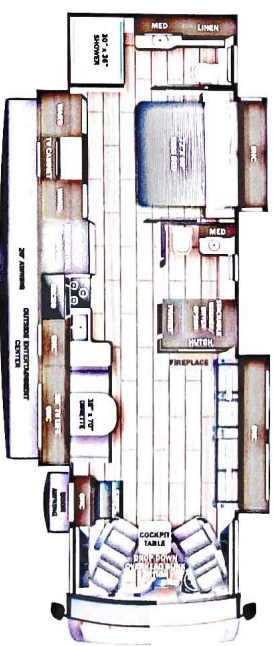

DIMENSIONS

Exterior height:.....154.00"
 Exterior width:.....101.00"

CAPACITIES

Fresh water tank (gals.):.....72.00
 Gray water tank (gals.):.....72.00
 Black water/collect tank (gals):.....72.00
 Propane (lbs.):.....56
 Propane (gals.):.....13
 Water heater (gals.):.....10.00

TIRES

Tire size (front):.....255/80R22.5S
 Tire size (mid):.....255/80R22.5S
 Tire size (rear):.....255/80R22.5S

Some dimensions may be rounded and may vary from the actual dimensions
 Weights may be estimated calculations and may vary from the actual weights
 - refer to the vehicle weight labels for actual weights***
 Floorplans, features and specifications are subject to change without notice.