



**ENTEGRA**  
COACH®

## Accolade



Serial #: 1JSNECBU8L1HB8095  
Model: 37TS ACCOLADE MHC  
VIN#:

Model Year: 2020 Dealer Name: NATIONAL INDOOR RV CENTERS  
1350 HURRICANE SHOALS ROAD  
LAWRENCEVILLE, GA 30043  
USA

### Standard Equipment

THE FOLLOWING ITEMS ARE STANDARD ON THIS MODEL  
AT NO EXTRA CHARGE

- One-piece fiberglass cap w/automotive bonded windshield
- Bead-foam insulation (R-24 max roof, R-9 max floor and R-8 max walls)
- High-gloss, Gelcoat vacuum-bonded, laminated sidewalls, crowned roof and floor
- 15K A/C w/heat pump & 13.5K A/C
- Black holding tank sprayer
- Thetford Sani-Con Turbo macerator system
- 12V electrical system with 120V, 80-amp power converter
- Onan® 8,000-watt Quiet Diesel generator and auto-gen start
- 35,000-BTU auto-ignition furnace with digital wall thermostat
- 2,000-watt pure sine inverter
- 56-pound propane tank, LP quick-connect hookup
- Water filtration system
- 10-gallon gas/electric water heater
- Fiberglass entrance door with oversized frameless window
- Electric-powered entrance step
- Deluxe full-body paint with Diamond Shield
- Exterior entertainment center with AM/FM/CD/DVD player and 39-inch LED TV and 2 speakers
- Keyless entry, touchpad locking system
- Deluxe heated, remote-control, sideview mirrors
- Outside shower
- 12V electric awning with LED lights
- Electric power cord reel with 50-amp service
- Winegard® In-motion satellite dish
- Slideout awning toppers
- Dual Pane Frameless windows, Dual-pane, tinted, safety-glass windows
- Backup/sideview cameras with monitor
- Ultra Leather Driver Passenger Seats
- Hydraulic automatic-leveling jacks
- Systems monitor panel
- Auxiliary start switch
- Soundstream Infotainment Dash Radio w/GPS & CD/DVD Player
- Sun Folding Windshield Shade
- One-piece fiberglass cap w/automotive bonded windshield
- Under-bed storage, bed lifts easily on gas struts (select models)
- Residential medicine cabinet with mirror
- Bunk beds (300-pound rating) (37L)
- Raised panel hardwood cabinetry, Deluxe hidden cabinet hinges
- Full cab-over bunk (750-pound rating)
- Padded vinyl ceiling
- 7" VegaTouch touch screen coach systems control panel
- Blu-Ray™ with HDMI® connections to all televisions
- 37HJ, 37K, 37L, 37RB (N/A 37TS)
- Premium vinyl flooring
- Flexsteel
- Multiplex
- High-intensity recessed LED ceiling lights
- Cable TV hookup with RG-6 coax & video selector switch
- Exclusive easy operation legless dinette table
- Ball-bearing drawer guides
- Solid-surface countertops with decorative backsplash
- Convection microwave
- 21 cu.ft. Residential Refrigerator
- King-sized bed with bedspread
- 32" LED HDTV in bedroom
- One-piece fiberglass shower with glass shower door, Skylight in shower with light
- Porcelain stool with foot pedal
- Carbon monoxide detector
- Propane alarm
- 2-point lap safety belts on all seating areas

Customer Value Package  
-2,000 Watt Inverter  
-Backup & Sideview Cameras  
-Convection Microwave  
-Electric Awning w/LED Lights  
-Electric Power Cord Reel  
-Frameless Windows  
-Infotainment System  
-EZ-Drive Premium  
-Residential Refrigerator

### Optional Equipment

OPTIONAL EQUIPMENT INSTALLED ON THIS VEHICLE  
BY MANUFACTURER

Base price	257,243.00
Windsor	n/c
Full Fawn Paint	n/c
USA Standards	n/c
20 FR S2RV 29000 279"	
360 LXT	n/c
Customer Value Package	6,750.00
Residential Refrigerator	n/c
No Washer/Dryer	n/c
IN Motion Satellite Dish	n/c
Booth Dinette	n/c
Hide-A-Bed Sofa	n/c

UNIT TOTAL

**263,993.00**

DEALER INSTALLED OPTIONS



# Manufacturer's Suggested Retail Price

\$263,993.00

TOTAL AMOUNT DOES NOT INCLUDE STATE AND LOCAL TAXES OR LICENSE FEES. THE PRICE SHOWN ABOVE MAY OR MAY NOT BE REPRESENTATIVE OF THE ACTUAL SELLING PRICE OF SIMILAR RECREATIONAL VEHICLES IN YOUR AREA.

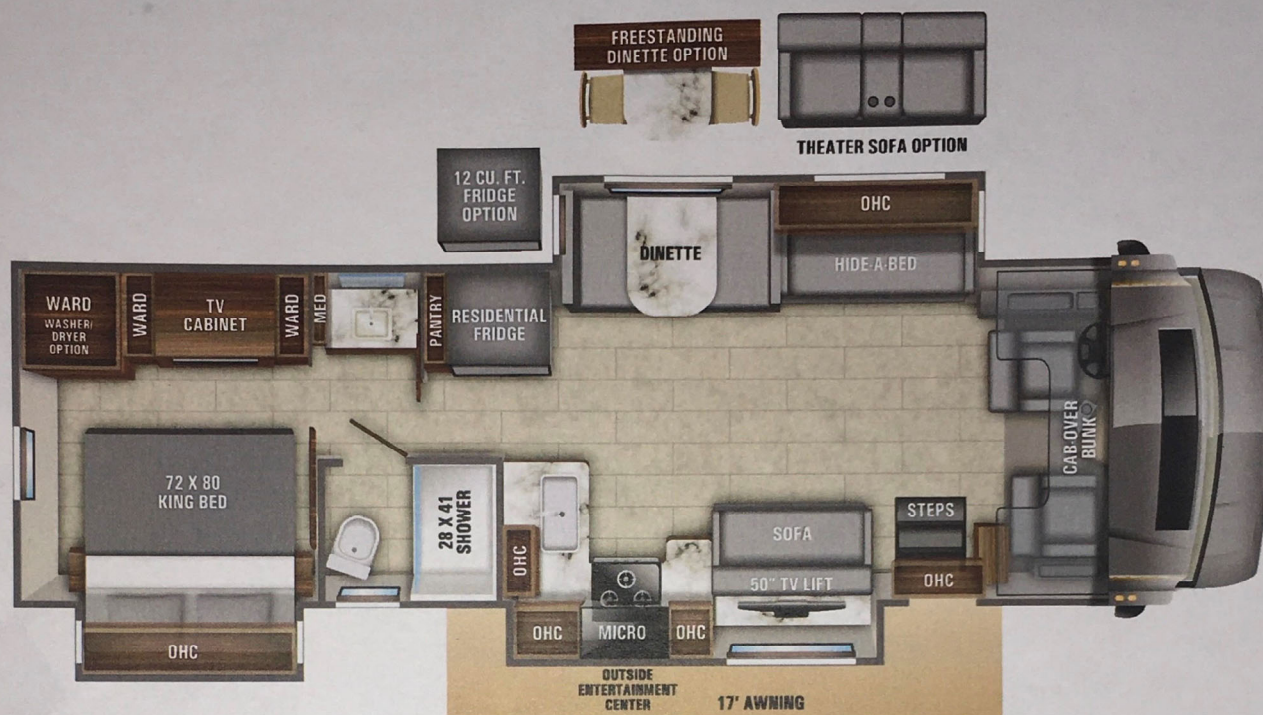

 **Sleeps**  
5-10

## DIMENSIONS

Exterior height:.....160.00"  
Exterior width:.....101.00"

## CAPACITIES

Fresh water tank (gals.):...72.00  
Gray water tank (gals.):...40.00  
Black water/toilet tank (gals.):.....50.00  
Propane (lbs.):.....83  
Propane (gals.):.....19  
Water heater (gals.):.....10.00

## SEATING & SLEEPING

King Bed.....72 X 80

## TIRES

Tire size (front):.....275/80R22.5G  
Tire size (mid):.....  
Tire size (rear):.....275/80R22.5G

\*\*\*Some dimensions may be rounded and may vary from the actual dimensions\*\*\*

\*\*\*Weights may be estimated calculations and may vary from the actual weight

- refer to the vehicle weight labels for actual weights\*\*\*

Floorplans, features and specifications are subject to change without notice.

**2+3**  
**YEAR | YEAR**  
LIMITED | STRUCTURAL  
**WARRANTY**