



## Seneca



Serial #: 1UJNJCBU7M1HL4092  
 Model: 37L SENECA MHC  
 VIN#: 4UZADVFC4MCMR4886  
 Model Year: 2021

Dealer Name: NATIONAL INDOOR RV CENTERS  
 11280 N SOLAR CONYON WAY  
 SURPRISE, AZ 85379  
 USA

### Standard Equipment

THE FOLLOWING ITEMS ARE STANDARD ON THIS MODEL  
 AT NO EXTRA CHARGE

Interior  
 Fireflyline® S2RV chassis  
 Cummins® ISB 6.7L 360 HP diesel engine with 800  
 ft-lb torque  
 Allison® 3000 MH automatic transmission  
 85-amp alternator  
 16-rated highway tires - 275/80R22.5  
 Local® aluminum rims  
 Engine exhaust brake  
 2,000-lb. rear hitch receiver with 7-pin plug  
 Dual 12V chassis batteries  
 60 gal. fuel tank  
 0 gal. DEF tank  
 ThresholdVBL™ Vacuum-Bond laminated roof, floor  
 & sidewalls  
 Premium Sikkens full body paint  
 Lead-foam insulation (R-24 max roof, R-9 max  
 & R-8 max walls)  
 One-piece, seamless, crowned fiberglass roof  
 Entrance door with industry's largest travel view  
 door  
 Electric-powered entrance step  
 Slideout cover awnings  
 Exterior entertainment center with outside speakers,  
 2 TV mounted on swivel bracket and single-disc  
 D/CD/AM/FM radio  
 Carpeted, full pass-through storage compartments  
 1 lockable slam latch doors  
 Max® 8,000-watt Quiet Diesel generator and  
 2-gen start  
 4.5 gal. propane tank (83 lb.)  
 Lock tank flush  
 Outside shower  
 Automatic hydraulic leveling jacks  
 Inegard® In-motion satellite dish  
 Hettford® Sani-Con Turbo Macerator system  
 P quick-connect hookup  
 Exterior utility center  
 Interiorization drain system  
 2V demand water pump  
 1) 6V AGM (220Ah) house batteries on slideout

Interior  
 - Firefly Multiplex system  
 - 84 in. interior ceiling height with padded vinyl ceiling  
 - Ball-bearing drawer guides  
 - Raised-panel, hardwood cabinetry throughout  
 - Deluxe hidden cabinet hinges  
 - LED lit solid surface kitchen countertops with integrated  
 stainless steel sink and sink covers  
 - Furrion® stainless recessed gas cooktop  
 - Decorative kitchen backsplash  
 - Flip-up countertop extension (select models)  
 - Water filtration system  
 - Jayco-exclusive easy operation legless dinette table  
 - 2-point lap safety belts in all designated seating locations  
 - Tile like vinyl flooring  
 - Systems monitor panel  
 - High-intensity recessed LED ceiling lights  
 - 34,000 BTU auto-ignition furnace  
 - Furrion® electric fireplace (N/A 37TS)  
 - Blu-Ray™ with HDMI® connections to all televisions  
 - Cable TV hookup with RG-6 coax and video selector switch  
 - LED lit stainless steel bathroom sink  
 - Porcelain toilet with foot flush  
 - One-piece, fiberglass shower with glass door, skylight and  
 light  
 - Powered roof vent in bathroom with wall switch  
 - Walk-around King-sized bed with bedspread and  
 nightstands  
 - Under-bed storage, bed lifts easily on gas struts (select  
 models)  
 - LED TV in bedroom  
 - Overhead bunk with 750 lb. capacity  
 - Bunks with industry-exclusive 300 lb. capacity each (37FS)  
 - Smoke alarm  
 - Carbon monoxide detector  
 - Deluxe heated, remote-controlled, sideview mirrors  
 - Power driver and passenger seats  
 - Driver and passenger air bags  
 - Power windows and door locks  
 - Tilt steering wheel  
 - A/C and cruise control  
 - Auxiliary start switch  
 - Privacy curtains for cab area

Customer Value Package  
 - JRIIDE® PREMIUM: Rear air suspension, heavy-duty rear  
 stabilizer bar, full air brakes, SACHS shocks  
 - Sony® infotainment center Apple CarPlay® and Android  
 Auto™  
 - One-piece, seamless, fiberglass front and rear caps  
 - Automotive-bonded, panoramic window in front cap with  
 power shade  
 - Backup and side-view cameras  
 - Dual-pane, tinted, safety-glass windows  
 - 15,000 BTU A/C unit with heat pump and second 13,500  
 BTU A/C unit  
 - 2,000-watt pure sine wave inverter  
 - Power cord reel with 50-amp service  
 - Electric patio awning with LED lights  
 - 21 cu.ft. residential refrigerator with ice and water in door  
 - Convection microwave  
 - 10 gal. gas/electric water heater

### Optional Equipment

OPTIONAL EQUIPMENT INSTALLED ON THIS VEHICLE  
 BY MANUFACTURER

Base price	263,175.00
Richmond	n/c
Mahogany Paint Package	n/c
USA Standards	n/c
21 FR S2RV 31000 279"	
360 MXX3	n/c
Customer Value Package	6,750.00
Residential Refrigerator	n/c
No Washer/Dryer	n/c
IN Motion DISH Satellite System	n/c
Hide-A-Bed Sofa	n/c

UNIT TOTAL

269,925.00

DEALER INSTALLED OPTIONS

# Manufacturer's Suggested Retail Price \$269,925.00

TOTAL AMOUNT DOES NOT INCLUDE STATE AND LOCAL TAXES OR LICENSE FEES. THE PRICE SHOWN ABOVE MAY OR MAY NOT BE REPRESENTATIVE OF THE ACTUAL SELLING PRICE OF SIMILAR RECREATIONAL VEHICLES IN YOUR AREA.

#5009

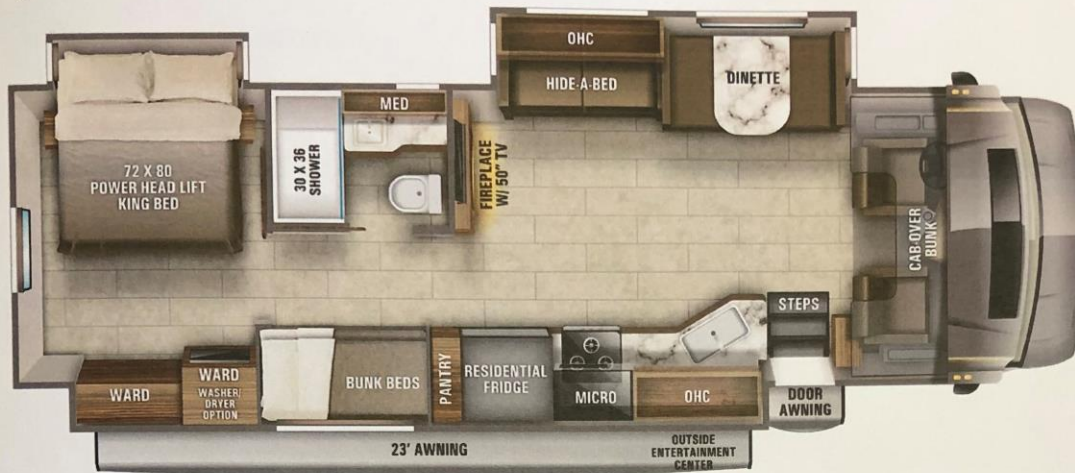

### DIMENSIONS

Exterior height:.....160.00"  
 Exterior width:.....101.00"

### CAPACITIES

Fresh water tank (gals.):...72.00  
 Gray water tank (gals.):...81.00  
 Black water/toilet tank (gals.):.....50.00  
 Propane (lbs.):.....83  
 Propane (gals.):.....19  
 Water heater (gals.):.....10.00

### TIRES

Tire size (front):.....275/80R22.5G  
 Tire size (mid):.....  
 Tire size (rear):.....275/80R22.5G

\*\*\*Some dimensions may be rounded and may vary from the actual dimensions\*\*\*  
 \*\*\*Weights may be estimated calculations and may vary from the actual weight  
 - refer to the vehicle weight labels for actual weights\*\*\*  
 Floorplans, features and specifications are subject to change without notice.

