



# ENTEGRA

COACH®

Accolade

5169



Serial #: 1JUSNECBU2M1HK8160  
 Model#: 37K ACCOLADE MHC  
 VIN#: 4UZADVFC8MCMCA3360  
 Model Year: 2021 Dealer Name: NATIONAL INDOOR RV CENTERS  
 4640 NEXUS WAY  
 NORTH LAS VEGAS, NV 89115

## Standard Equipment

THE FOLLOWING ITEMS ARE STANDARD ON THIS MODEL AT NO EXTRA CHARGE

- Entegra® S2RV chassis
- Engine: 6.7L 360 HP diesel engine with 800 ft. lb. torque
- Also: 3000 MH automatic transmission
- 185-amp alternator
- Engine fire protection system
- Engine fire extinguisher 275/80R22.5
- 12,000-lb. hitch with 1,200-lb. tongue capacity and 7-pin plug
- Chassis batteries
- 10 gal. DEF tank
- TuffShell™ vacuum-bond laminated roof, floor and sidewalls, seamless, crowned fiberglass roof
- Aluminum Slikens full body paint
- Deluxe treated, remote-controlled, sideview mirrors with adjustable alarm light doors
- Bead-bar insulation (R-24 max roof, R-9 max floor and R-9 max walls)
- Ice door with industry's largest travel view window
- Electric-powered entrance step
- Standard cover awnings
- LED TV entertainment center with outside speakers, DVD/CD/AM/FM radio
- On-board 8,000-watt Quiet Diesel generator and 40-gal. propane tank (83 lb.)
- (4) 6V AGM (220Ah) house batteries on slideout tray
- Seat prep
- Entegra® family center
- Wet/dry storage system
- 12V demand water pump
- Black tank flush
- Black tank flush
- Automatic hydraulic leveling jacks
- Wireguard® in-motion satellite dish
- Thermostat Smart-Cool Turbo Maxerator system
- Third brake light
- Power light
- Roof ladder

## Optional Equipment

OPTIONAL EQUIPMENT INSTALLED ON THIS VEHICLE BY MANUFACTURER

- Interior
- Power driver and passenger seats
- Power windows and door locks
- Power windows with auto-lock
- Tilt steering wheel
- Auxiliary start switch
- Privacy curtains for cab area
- 84 in. interior ceiling height with padded vinyl ceiling
- Firefly Multiplex system
- Bull-bearing drawer guides
- Furniture: kitchen cabinets, cabinetry throughout
- Furniture: stainless, recessed, gas cooktop with cast iron grill
- Deluxe hidden cabinet storage (selected models)
- Flip-up countertop extension (selected models)
- LED lighting system with LED strip lighting with recessed stainless steel sink and sink covers
- Water filtration system
- Entegra-exclusive easy operation legless dinette table
- High-intensity, recessed LED ceiling lights
- Vinyl plank flooring
- 35,000 BTU auto-ignition furnace (37F5)
- Blue-Ray™ with HDMI® connections to all televisions
- Cable TV hookup with RG-6 coax and video selector switch
- Porcelain toilet with foot flush
- Light "peep", fiberglass shower with glass door, skylight and recessed LED lit stainless steel bathroom sink
- Powered roof vent in bathroom with wall switch
- Under-bed storage (select models)
- LED TV in bedroom
- Overhead bunk with 750 lb. capacity
- Bunks with industry-exclusive 300 lb. capacity each (37F5)
- Smoke alarm
- Carbon monoxide detector
- Customer Value Package
- EZDRIVE™ PREMIER Computer-balanced driveshaft, rear Bilstein suspension, heavy-duty rear stabilizer bar, full air brakes, Sony® in-plant center with Apple CarPlay® and Android Auto™
- One-piece, seamless, fiberglass front and rear caps
- Power shade
- Backup and sideview cameras
- Deluxe, tinted, safety-glass windows
- 12V AC unit with A/C unit with heat pump and second 13,500 BTU AC unit
- 2,000-watt pure sine wave inverter
- Power cord reel with 50-amp service
- 21-circuit, residential temperature lights and water in door
- Residential-sized convection microwave

DEALER INSTALLED OPTIONS

UNIT TOTAL 273,729.00

Manufacturer's Suggested Retail Price \$273,729.00

TOTAL AMOUNT DOES NOT INCLUDE STATE AND LOCAL TAXES OR LICENSE FEES. THE PRICE SHOWN ABOVE MAY OR MAY NOT BE REPRESENTATIVE OF THE ACTUAL SELLING PRICE OF SIMILAR RECREATIONAL VEHICLES IN YOUR AREA.

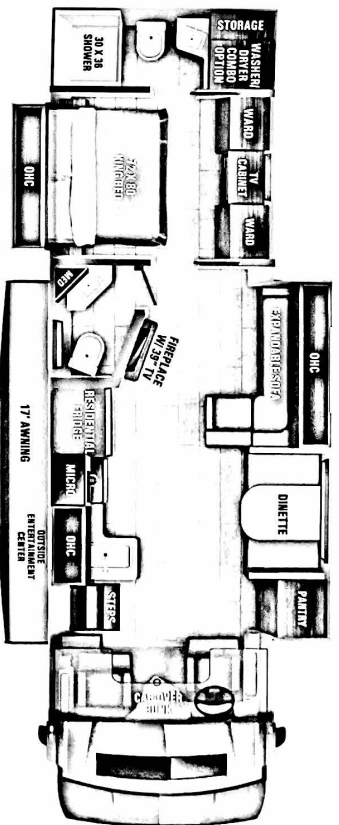

### DIMENSIONS

Exterior height: 160.00"  
 Exterior width: 101.00"

### CAPACITIES

Fresh water tank (gals.): 72.00  
 Gray water tank (gals.): 91.00  
 Black water/toilet tank (gals.): 63.00  
 Propane (lbs.): 83  
 Propane (gals.): 19  
 Water heater (gals.): 10.00

### TIRES

Tire size (front): 275/80R22.56  
 Tire size (mid): .....  
 Tire size (rear): 275/80R22.56

\*\*\*Some dimensions may be rounded and may vary from the actual dimensions\*\*\*  
 \*\*\*Weights may be estimated calculations and may vary from the actual weight\*\*\*  
 - refer to the vehicle weight labels for actual weights\*\*\*  
 Floorplans, features and specifications are subject to change without notice.