



ENTEGRA  
COACH®

Esteeem



Serial #: 1JSLECBR3N1B8V173  
Model: 29V ESTEEM MHC  
VIN#: 1FDXE4FN9NDC36488  
Model Year: 2022 Dealer Name: NATIONAL INDOOR RV CENTERS  
1350 HURRICANE SHOALS ROAD  
LAWRENCEVILLE, GA 30043  
USA

Manufacturer's Suggested Retail Price \$178,233.00

TOTAL AMOUNT DOES NOT INCLUDE STATE AND LOCAL TAXES OR LICENSE FEES. THE PRICE SHOWN ABOVE MAY OR MAY NOT BE REPRESENTATIVE OF THE ACTUAL SELLING PRICE OF SIMILAR RECREATIONAL VEHICLES IN YOUR AREA.

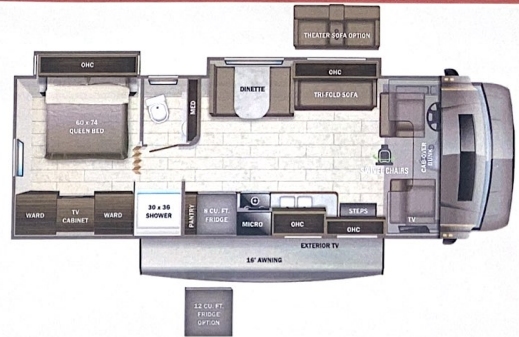

Standard Equipment

Optional Equipment

THE FOLLOWING ITEMS ARE STANDARD ON THIS MODEL AT NO EXTRA CHARGE

OPTIONAL EQUIPMENT INSTALLED ON THIS VEHICLE BY MANUFACTURER

- EXTERIOR**
- Ford® E-450 chassis
  - GVWR - 14,500 lb.
  - GCWR - 22,000 lb.
  - 7.3L V-8 350 HP engine with 468 ft.-lb. torque
  - 6-speed TorqShift® series transmission with overdrive
  - 210-amp alternator
  - E-rated highway tires - LT225/76R16
  - Power anti-lock brakes with power steering
  - 7,500-lb. hitch with 750-lb. tongue capacity and 7 pin-plug
  - 12V chassis battery
  - 55-gal. fuel tank
  - Onan® 4,000-watt MicroQuiet™ generator with auto-changover
  - Transfer switch with reverse polarity protection
  - 30-amp electrical service
  - 12V house battery
  - 180W solar panel with dual controller and second house battery
  - Heated holding tanks (12V pads)
  - 15,000-BTU A/C with heat pump
  - 30,000-BTU auto-ignition furnace
  - 6-gal. gas/electric DSI auto-ignition water heater
  - 16.5-gal. propane tank (56 lb.)
  - LP quick-connect hookup
  - Exterior utility center
  - Winterization drain system
  - Black tank flush
  - Outside shower
  - 12V demand water pump
  - Water filtration system
  - TuffShell™ vacuum-bond laminated roof, floor and sidewalls
  - Bead-foam insulation (R-24 max roof, R-9 max floor, R-6 max walls)
  - One-piece, seamless, fiberglass roof
  - Fiberglass running boards
  - Fiberglass side wings
  - Fiberglass exterior walls with vinyl graphics
  - Entrance door with industry's largest travel-view window
  - Electric-powered entrance step with integrated house battery compartment
  - Slidolite cover awnings
  - Lockable storage compartments with slam latches
  - 4-in. bumper face sewer hose storage
  - Roof ladder
  - Trond brake light

- INTERIOR**
- Remote keyless cab entry
  - Swivel driver and passenger seats with boosters (NIA 30X)
  - Tire pressure monitoring system (TPMS)
  - Power windows and door locks
  - A/C and cruise control
  - Tilt steering wheel
  - Auxiliary start switch
  - Privacy curtains for cab area
  - Custom-modded ABS surround in cab-over area
  - Overhead bunk with 750 lb. capacity and safety net (fit in, interior ceiling height with padded vinyl ceiling)
  - High-intensity recessed LED ceiling lights
  - LED lit faces with decorative insert
  - Hardwood cabinet doors and drawers
  - Ball bearing drawer guides
  - Blackout night roller shades
  - Interior command center
  - Entegra exclusive, easy operation logless dinette table
  - LED HD Smart Fire TV in living area
  - Prep for satellite dish
  - Cable TV hookup with RG-6 coax
  - Winegard 2.0 WiFi/G antenna
  - 8-cu. ft. gas/electric refrigerator
  - Furrform® all-in-one cooking and oven
  - Residential-size microwave
  - Recessed stainless steel kitchen sink with solid-surface covers
  - Flip-up countertop extension (select models)
  - Decorative kitchen backsplash
  - Pop-up charging station in kitchen with 110 outlets and USB ports
  - Shower with decorative surround, glass door, skylight and light
  - Recessed stainless steel bathroom sink
  - Porcelain toilet with foot flush
  - Powered roof vent in bathroom with wall switch
  - Walk-around, Queen-size bed with bedspread and nightstands (King size in 2TU)
  - Under-bed storage (select models)
  - Powered roof vent in bedroom with wall switch
  - Large wardrobe
  - Bunks with industry-exclusive 300-lb. capacity elch (31F)
  - 2-point lap safety belts in all designated seating locations
  - Driver and passenger airbags
  - Single alarm
  - Carbon monoxide detector

- CUSTOMER VALUE PACKAGE**
- EZ DRIVE™ ELITE, Computer-balanced driveshaft, Konig® FSD shocks, heavy-duty rear stabilizer bar, standard front stabilizer bar, Hellwig® helper springs, rubber isolation mounts
  - One-piece, seamless, fiberglass front cap
  - Automotive-bonded panoramic window in front cap with power shade
  - Automatic hydraulic leveling jacks
  - Frameless windows
  - Electric patio awning with LED lights
  - Exterior LED TV with (2) high-output, marine-grade exterior speakers
  - 1,000-watt inverter
  - Chrome, heated, remote-controlled, side-view mirrors
  - Sony® infotainment center with Apple CarPlay® and Android Auto™
  - Backup and side-view cameras
  - LED lit, solid-surface kitchen countertops
  - LED TV in bedroom

Base price	153,743.00
Brighton	n/c
Meadow Lark Full Body	n/c
Paint	8,243.00
USA Standards	n/c
22 FD E45 14500 158"	n/c
7.3L WHITE NC10	n/c
Customer Value Package	9,000.00
Dual A/Cs	1,193.00
12 Cu. Ft. Refrigerator	2,843.00
Aluminum Rims	2,393.00
Standard House Battery	n/c
Sun Folding Windshield Shade	443.00
Theater Seating Sofa	375.00

UNIT TOTAL 178,233.00

DEALER INSTALLED OPTIONS

DIMENSIONS

Exterior height:.....140.00"  
Exterior width:.....100.00"

CAPACITIES

Fresh water tank (gals.):...47.00  
Gray water/toilet tank (gals.):...41.00  
Black water/toilet tank (gals.):...32.00  
Propane (lbs.):...56  
Propane (gals.):...13  
Water heater (gals.):...0.00

TIRES

Tire size (front):.....LT225/75R16E  
Tire size (mid):.....  
Tire size (rear):.....LT225/75R16E

\*\*\*Some dimensions may be rounded and may vary from the actual dimensions\*\*\*  
\*\*\*Weights may be estimated calculations and may vary from the actual weight - refer to the vehicle weight labels for actual weights\*\*\*  
Floorplans, features and specifications are subject to change without notice.