

5746



# ENTEGRA COACH®

## Vision XL



Serial #: 1JSWEABT1M1UG8155  
 Model: 34G VISION XL MHA  
 VIN#: 1F66F5DN5L0A15483  
 Model Year: 2021 Dealer Name: NATIONAL INDOOR RV CENTERS

4640 NEXUS WAY  
 NORTH LAS VEGAS, NV 89115  
 USA

### Standard Equipment

- Exterior F53 chassis
- 7.3L V-8 350 HP engine with 488 ft.-lb. torque
- 6-speed automatic FordShift® transmission with overdrive and tow haul mode
- 210-amp alternator
- G-rated highway tires- 235/80R22.5 (34B, 34G), 255/80R22.5 (36A)
- Front and rear disc, 4-wheel anti-lock brakes
- 5,000 lb. rear hitch receiver with dual connector with 7-pin plug
- 12V chassis battery
- 80 gal. fuel tank
- 120 in. panoramic windshield
- TuffShell™ vacuum-bond laminated roof, floor and sidewalls
- Bead-foam insulation (R-24 max roof, R-9 max floor, R-8 max walls)
- One-piece, seamless, fiberglass front and rear caps
- One-piece, seamless, crowned fiberglass roof
- Fiberglass exterior walls with vinyl graphics
- Entrance door with industry's largest travel view window
- Electric-powered entrance step
- Third brake light
- Lockable pass-through storage compartments with slam latches
- (2) 6V AGM (220Ah) house batteries on slideout tray
- 16.5 gal. propane tank (56 lb.)
- Solar prep
- Heated holding tanks (12V pads)
- LP quick-connect hookup
- Exterior utility center
- Writenization drain system
- Black tank flush
- Outside shower
- Porch light
- Roof Ladder

THE FOLLOWING ITEMS ARE STANDARD ON THIS MODEL AT NO EXTRA CHARGE

OPTIONAL EQUIPMENT INSTALLED ON THIS VEHICLE BY MANUFACTURER

### Optional Equipment

- Interior
- Power front privacy shade with manual side privacy shades
- 6-way power and swivel driver and passenger seats
- Soft-touch, vinyl wrapped automotive dash
- A/C and cruise control
- Tilt steering wheel
- Auxiliary start
- 84 in. interior ceiling height with padded vinyl ceiling
- LED lit hardwood fascia
- Ball-bearing drawer guides
- Hardwood cabinet doors and drawers
- Auto-ignition ducted furnace-35,000-BTU (34B, 34G), (2)30,000 BTU (36A)
- Furnon® electric fireplace (34B, 34G only)
- 21 cu.ft. residential refrigerator with ice and water in door
- Furnon® all-in-one cooktop and oven
- Residential-sized microwave
- Powered roof vent in kitchen with wall switch
- Decorative kitchen backsplash
- 12V demand water pump
- Digital antenna with signal booster
- Water filtration system
- Entegra-exclusive easy operation legless dinette table
- 2-point lap safety belts in all designated seating locations
- High-intensity, recessed LED ceiling lights
- Blu-Ray™ player in living area
- Cable TV hookup with RG-6 coax and video selector switch
- Prep for satellite dish
- Recessed stainless steel bathroom sink
- Porcelain toilet with foot flush
- Shower with decorative surround, glass door, skylight and light
- Powered roof vent in bathroom with wall switch
- Walk-around King-sized bed with bedspread and nightstands
- Under-bed storage (select models)
- Large wardrobes
- LED TV in bedroom
- Bunks with industry-exclusive 300 lb. capacity each (36A)
- Smoke alarm
- Carbon monoxide detector

Base price	156,833.00
Crossville	n/c
Basante Paint Package	12,750.00
USA Standards	n/c
Customer Value Package	11,250.00
Residential Refrigerator	n/c
No Washer/Dryer	n/c
Front Bunk Overhead	2,993.00

- Customer Value Package
- EZDRIVE™: Computer-balanced driveshaft, Jounce bumpers, heavy-duty front and rear stabilizer bars, SACHS shocks
- Sony® infotainment center with Apple CarPlay® and Android Auto™
- Automatic hydraulic leveling jacks
- Backup and siderview cameras
- Frameless windows
- Oran® Marquis Gold Genset 5,500-watt generator with auto-gen start
- 1200-watt inverter
- 50-amp electrical service
- Electric patio awning with LED lights
- Slideout cover awnings
- Exterior entertainment center with outside speakers, LED TV mounted on swivel bracket and single-disc DVD/MP3 radio
- LED living room TV
- LED lit solid surface kitchen countertops with recessed stainless steel sink and sink covers
- Removable driver/passenger cockpit table
- Day/night roller shades
- 15,000 BTU A/C unit with heat pump and second 13,500 BTU A/C unit

UNIT TOTAL **183,826.00**

DEALER INSTALLED OPTIONS

## Manufacturer's Suggested Retail Price \$183,826.00

EXcludes destination charge, taxes, title, license fees, the price shown above may or may not be representative of the actual selling price of similar recreational vehicles in your area.

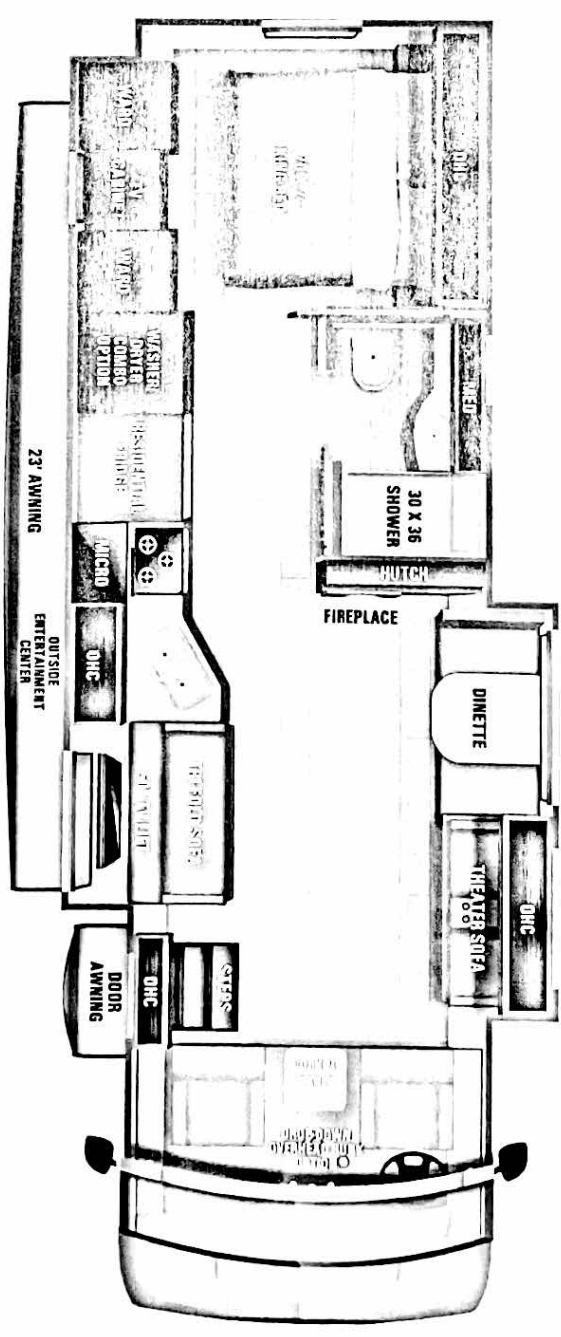

- DIMENSIONS**
- Exterior height:.....154.00"
- Exterior width:.....101.00"
- CAPACITIES**
- Fresh water tank (gals.):.....72.00
- Gray water tank (gals.):.....40.00
- Black water/toilet tank (gals.):.....50.00
- Propane (lbs.):.....56
- Propane (gals.):.....13
- Water heater (gals.):.....10.00

- TIRES**
- Tire size (front):.....255/80R22.5G
- Tire size (mid):.....
- Tire size (rear):.....255/80R22.5G

\*\*\*Some dimensions may be rounded and may vary from the actual dimensions\*\*\*  
 \*\*\*Weights may be estimated calculations and may vary from the actual weight\*\*\*  
 - refer to the vehicle weight labels for actual weights\*\*\*  
 Floorplans, features and specifications are subject to change without notice.