



Serial #: 1UJNJCBU1N1HL4106
Model: 37L SENECA MHC
VIN#: 4UZADVFC8NCNR9433
Model Year: 2022 Dealer Name: NATIONAL INDOOR RV CENTERS
11280 N SOLAR CANYON WAY
SURPRISE, AZ 85379
USA

Standard Equipment

**THE FOLLOWING ITEMS ARE STANDARD ON THIS MODEL
AT NO EXTRA CHARGE**

EXTERIOR

- Freightliner® S22RV chassis
- GVWR- 29,000 lb.
- GCWR- 41,000 lb.
- Cummins® ISB 6.7L 360 HP diesel engine with 800 ft.-lb. torque
- Allison® 3000 MH automatic transmission
- 185-hp alternator
- G-rated highway tires- 275/82R25
- Alcoa® aluminum rims
- Engine exhaust brake
- 12,000-lb. rear hitch receiver
- 7-pin plug
- Dual 12V chassis batteries
- 100 gal. fuel tank
- 10 gal. DEF tank
- Deluxe heated, remote-controlled, side-view mirrors
- Vinyl®/Burl™ roof, floor and sidewalls
- Bead-head insulation (R-24 max floor, R-9 max floor and R-5 max walls)
- One-piece, seamless, crowned fiberglass roof
- Premix Sikaflex® full-body paint
- Automatic hydraulic leveling jacks
- Entrance door with industry's largest view window
- Window
 - Electric-powered entrance step
 - Slideout cover awnings
- Exterior entertainment center with outside speakers, LED TV mount, swivel bracket and single-disc DVD/CD/AM/FM radio
- Winegard® In-motion satellite dish
- Carpeted, full pass-through storage compartments
- Wet lockable, slam latch doors
- 24.5 gal. propane tank (83 lb.)
- LP quick-connect hookup
- Theford® Sani-Con Turbo Macerator system
- Exterior utility cabinet
- Winterization drain system
- Black tank flush
- Outside shower
- 12V demand water pump
- Onan® 8,000-watt Qset Diesel generator and auto-gen start
- Remote switch with reverse polarity protection
- (4) 6V AGM (220Ah) house batteries on slideout tray
- 190W solar panel with dual controller
- Flush-mount LED marker lights
- Three brake light

INTERIOR

- **INTERIOR**
- Driver and passenger airbags
- Power windows and door locks
- Tilt steering wheel
- A/C and cruise control
- Auxiliary start switch
- Custom-molded ABS surround in cab-over area
- Overhead bunk with 750 lb. capacity
- JAYCO*MANDIR*™ powered by Firefly
- 84 in. interior ceiling height with padded vinyl ceiling
- High-intensity, recessed LED ceiling lights
- Vinyl plank flooring
- Raised panel, hardwood cabinetry throughout
- Deluxe hidden cabinet hinges
- Ball-bearing driver guides
- Jayco-exclusive, easy-operation legless dinette table
- 2-point lap safety belts in all designated seating locations
- 34,000 BTU air-conditioning furnace
- Furrion® electric fireplace (N/A 37TS)
- LED HD Smart Fire TV in living area
- Cable TV hookup with RG-6 coax and video selector switch
- Wireless 2.4 GHz antenna
- Wood framed kitchen window with spice cabinets
- 2-burner induction cooktop
- LED-lit, solid surface kitchen countertops with integrated stainless steel sink and sink covers
- Cut-out countertop for television (select models)
- Water filtration system
- One-piece, fiberglass shower with glass door, skylight and light
- Porcelain toilet with foot flush
- LED-lit, stainless-steel bathroom sink
- Powered roof vent in bathroom with wall switch
- Walk-around King-size bed with bedspread and nightstands
- Under-bed storage
- LED TV in bedroom
- Large wardrobes
- Bunks with industry-exclusive 300 lb. capacity each (37L)
- Smoke alarm
- Carbon monoxide detector

CUSTOMER VALUE PACKAGE

- **JRIDE® PREMIUM.** Computer-balanced drivetrain, rear air suspension, heavy-duty rear stabilizer bar, full air brakes, SACHS shocks
- One-piece, seamless, fiberglass front and rear caps
- Aluminum bonded, panoramic window in front cap with power shade
- Dual-pane, tinted, safety glass windows
- 12 to 15,000 BTU A/C units with heat pumps
- Electric panel awning with LED lights
- 2,000-watt pure sine wave inverter
- Power cord reel with 50-amp service
- Girard® tankless water heater
- Sony® infotainment center with Apple® CarPlay and Android Auto™
- Backup and side-view cameras
- Residential refrigerator
- Convection microwave oven

Optional Equipment

**OPTIONAL EQUIPMENT INSTALLED ON THIS VEHICLE
BY MANUFACTURER**

Base price	315,750.00
Crossville	n/c
Acadia Paint Package	30.00
USA Standards	n/c
22 FR S2RV 31000 279"	
360 NA15	n/c
Customer Value Package	6,750.00
12 Cu. Ft. Refrigerator	1,643.00
Washer/Dryer Combination	1,800.00
8K Generator	n/c
Trav'ler Direct TV	
Satellite Network	1,343.00
Slideout Tray w/Electric	
Cooler in Basement	1,125.00
Hide-A-Bed Sofa	n/c

UNIT TOTAL	328,441.00
------------	------------

DEALER INSTALLED OPTIONS

Manufacturer's Suggested Retail Price

\$328,441.00

TOTAL AMOUNT DOES NOT INCLUDE STATE AND LOCAL TAXES OR LICENSE FEES. THE PRICE SHOWN ABOVE MAY OR MAY NOT BE REPRESENTATIVE OF THE ACTUAL SELLING PRICE OF SIMILAR RECREATIONAL VEHICLES IN YOUR AREA.

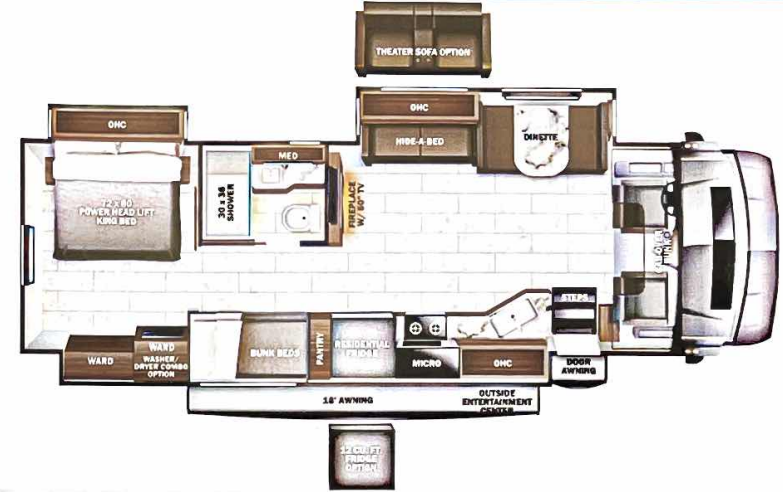

DIMENSIONS

Exterior height:.....160.00"
Exterior width:.....101.00"

CAPACITIES

```
* Fresh water tank (gals.):...72.00
* Gray water tank (gals.):...81.00
Black water/toilet tank
(gals.):.....50.00
Propane (lbs.):.....83
Propane (gals.):.....19
Water heater (gals.):.....0.00
```

TIRES

Tire size (front):.....275/80R22.5G
Tire size (mid):.....
Tire size (rear):.....275/80R22.5G

Some dimensions may be rounded and may vary from the actual dimensions

***Weights may be estimated calculations and may vary from the actual weight

- refer to the vehicle weight labels for actual weights***

Floorplans, features and specifications are subject to change without notice.

2+3
YEAR | YEAR
LIMITED | STRUCTURAL
WARRANTY