



## Greyhawk Prestige #6029



Serial #: 1UJLJCBR2M1BV4123  
Model: 29MVP GREYHAWK PRESTIGE MHC  
VIN#: 1FDXE4FN9MDC32956  
Model Year: 2021 Dealer Name: NATIONAL INDOOR RV CENTERS  
11280 N SOLAR CONYON WAY  
SURPRISE, AZ 85379  
USA

### Standard Equipment

THE FOLLOWING ITEMS ARE STANDARD ON THIS MODEL  
AT NO EXTRA CHARGE

**Exterior**

- Ford® E-450 chassis
- 7.3L V-8 350 HP engine with 468 ft.-lb. torque
- 6-speed TorqShift® series transmission with overdrive
- 210-amp alternator
- E-rated highway tires- LT225/75R16
- Power anti-lock brakes with power steering
- 7,500 lb. hitch with 750 lb. tongue capacity and 7-pin plug
- 12V chassis battery
- 55 gal. fuel tank
- Chrome, heated, remote-controlled, sideview mirrors
- Stronghold® VBL™ Vacuum-Bond laminated roof, floor and sidewalls
- Fiberglass exterior walls with vinyl graphics
- Bead-foam insulation (R-24 max roof, R-9 max floor, R-5 max walls)
- One-piece, seamless, crowned fiberglass roof
- Remote keyless entry
- Entrance door with industry's largest travel view window
- Electric-powered entrance step with integrated house battery compartment
- Slideout cover awnings
- Fiberglass running boards and transition wings
- Flush-mount LED marker lights
- Lockable storage compartments with slam latches
- 30-amp electrical service
- Onan® 4,000-watt MicroQuiet™ generator with auto-changover
- 12V house battery
- 16.5 gal. propane tank (56 lb.)
- LP quick-connect hookup
- Exterior utility center
- Winterization drain system
- Black tank flush
- Outside shower
- 4 in. bumper-tube with sewer hose storage
- Heated holding tanks (12V pads)
- Solar prep
- Third brake light
- Porch light

**Interior**

- Swivel driver and passenger seats (N/A 30XP)
- Tire pressure monitoring system (TPMS)
- Driver and passenger air bags
- Power windows and door locks
- Tilt steering wheel
- A/C and cruise control
- Auxiliary start switch
- Privacy curtains for cab area
- Custom molded ABS surround in cab-over area
- 84 in. interior ceiling height with padded vinyl ceiling
- Ball-bearing drawer guides
- Hardwood cabinet doors and drawers
- LED lit fascia with decorative insert
- 8 cu. ft. flush-mount, double door refrigerator
- Furrion® all-in-one cooktop and oven
- Integrated stainless steel kitchen sink with solid surface covers
- Residential-sized microwave
- Flip-up countertop extension (select models)
- Decorative kitchen backsplash
- Pop up charging station in kitchen with 110 outlets and USB ports
- 12V demand water pump
- Interior command center
- 15,000 BTU A/C with heat pump
- 31,000 BTU auto-ignition furnace
- Water filtration system
- Jayco-exclusive easy operation legless dinette table
- 2-point lap safety belts in all designated seating locations
- High-intensity, recessed LED ceiling lights
- Blackout night roller shades
- Blu-Ray™ player in living area
- Digital antenna with signal booster
- Cable TV hookup with RG-6 coax
- Prep for satellite dish
- Stainless steel sink in bathroom
- Toilet with foot flush
- Shower with decorative surround, glass door, skylight and light
- Powered roof vent in bathroom with wall switch
- Walk-around Queen-sized bed with bedspread and nightstands
- Under-bed storage (select models)
- Powered roof vent in bedroom with wall switch
- Overhead bunk with 750 lb. capacity
- Bunks with industry-exclusive 300 lb. capacity each (31FP)
- Smoke alarm
- Carbon monoxide detector

**Customer Value Package**

- JRI® PLUS: Computer-balanced drive shaft, Konig® FSD shocks, heavy-duty rear stabilizer bar, standard front stabilizer bar, Hellwig® helper springs, rubber isolation mounts
- Sony® infotainment center Apple CarPlay and Android Auto™
- One-piece, seamless fiberglass front cap
- Automotive-bonded, panoramic window in front cap with power shade
- Automatic hydraulic leveling jacks
- Backup and sideview cameras
- Frameless windows
- 1,000-watt inverter
- Electric patio awning with LED lights
- Exterior LED TV with high-output, marine grade exterior speakers
- LED TV in bedroom
- LED HDTV in living area
- LED lit solid surface kitchen countertops

### Optional Equipment

OPTIONAL EQUIPMENT INSTALLED ON THIS VEHICLE  
BY MANUFACTURER

Base price	127,493.00
Midnight	n/c
Electric Paint Package	9,585.00
USA Standards	n/c
21 FD E45 14500 158*	n/c
7.3L WHITE MXX	9,000.00
Customer Value Package	1,193.00
11,000 BTU AC (2)	n/c
8 Cu. Ft. Refrigerator	n/c
Steel Rims	n/c
Standard House Battery	n/c
Sun Folding Windshield	428.00
Shade	n/c
Sofa	n/c

UNIT TOTAL 147,699.00

DEALER INSTALLED OPTIONS

## Manufacturer's Suggested Retail Price \$147,699.00

TOTAL AMOUNT DOES NOT INCLUDE STATE AND LOCAL TAXES OR LICENSE FEES. THE PRICE SHOWN ABOVE MAY OR MAY NOT BE REPRESENTATIVE OF THE ACTUAL SELLING PRICE OF SIMILAR RECREATIONAL VEHICLES IN YOUR AREA.

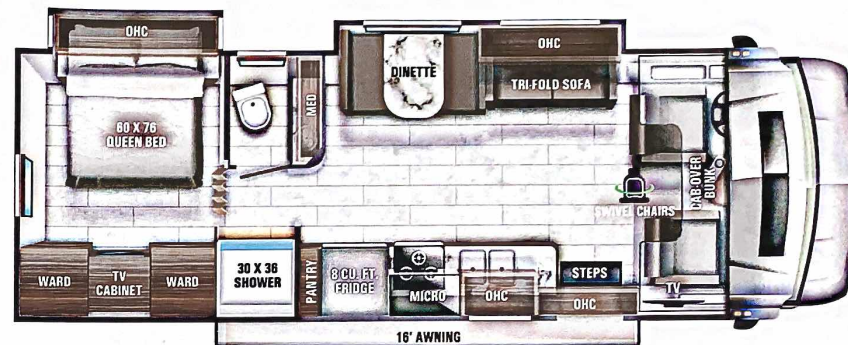

### DIMENSIONS

Exterior height:.....140.00"  
Exterior width:.....100.00"

### CAPACITIES

Fresh water tank (gals.):.....47.00  
Gray water tank (gals.):.....41.00  
Black water/toilet tank (gals.):.....32.00  
Propane (lbs.):.....56  
Propane (gals.):.....13  
Water heater (gals.):.....6.00

### TIRES

Tire size (front):.....LT225/75R16E  
Tire size (mid):.....LT225/75R16E  
Tire size (rear):.....LT225/75R16E

\*\*\*Some dimensions may be rounded and may vary from the actual dimensions\*\*\*

\*\*\*Weights may be estimated calculations and may vary from the actual weight

- refer to the vehicle weight labels for actual weights\*\*\*

Floorplans, features and specifications are subject to change without notice.

**2+3**  
YEAR | YEAR  
LIMITED STRUCTURAL  
WARRANTY