



## Seneca Prestige

#6223



Serial #: 1UJNJCBU2M1LK4054  
Model: 37K SENECA PRESTIGE MHC  
VIN#: 4UZADVFC2MCMS1712  
Model Year: 2021 Dealer Name: NATIONAL INDOOR RV CENTERS  
11280 N SOLAR CANYON WAY  
SURPRISE, AZ 85379  
USA

### Standard Equipment

THE FOLLOWING ITEMS ARE STANDARD ON THIS MODEL  
AT NO EXTRA CHARGE

**STANDARD EXTERIOR EQUIPMENT**  
-Freightliner® S2RV front engine diesel "Super-C" cab chassis  
-Front axle - 10,000 lb.  
-Drive axle - 21,000 lb.  
-Cummins® ISB 6.7L 360 HP diesel engine with 800 ft.-lb. torque  
-Allison® 3000 MH automatic transmission  
-185-amp alternator  
-Michell® tires- 275/80R 22.5 14 ply  
-Alcoa® aluminum rims  
-Variable geometry engine exhaust brake  
-12,000-lb. rear hitch receiver  
-7-pin plug  
-Dual 12V chassis batteries - 1900 CCA  
-100 gal. fuel tank  
-13 gal. DEF tank  
-Deluxe heated, remote-controlled, side-view mirrors  
-Power driver and passenger seats  
-Power windows and door locks  
-Tilt and telescoping leather-wrapped steering wheel  
-Auxiliary start switch  
-Stronghold® VBL™ Vacuum-Bond laminated roof, floor and sidewalls  
-Bead-foam insulation (R-24 max roof, R-9 max floor, R-5 max walls)  
-One-piece, seamless, crowned fiberglass roof  
-One-piece, seamless, fiberglass front and rear caps  
-Automotive-bonded panoramic window in front cap with power shade  
-Premium Sikkens full-body paint  
-Automatic hydraulic leveling jacks  
-Entrance door with industry's largest travel-view window  
-Electric-powered entrance step  
-Slideout cover awnings  
-Exterior entertainment center with outside speakers, LED TV mounted on swivel bracket and single-disc DVD/CD/AM/FM radio  
-Winegard® In-motion satellite dish  
-Carpeted, full pass-through storage compartments with lockable, slam latch doors  
-Chrome exterior baggage door handles and locks  
-Theftford® Sani-Con Turbo Macerator system  
-Exterior utility center  
-Winterization drain system  
-Black tank flush  
-Outside shower  
-12V demand water pump  
-Onan® 8,000-watt diesel generator with auto-gen start  
-(4) 6V AGM (220Ah) house batteries on slideout tray  
-Solar prep  
-Third brake light  
-Porch light with clear lens

**STANDARD INTERIOR EQUIPMENT**  
-Custom-molded ABS surround in cab-over-area  
-Overhead bunk with 750 lb. capacity  
-Privacy curtains for cab area  
-Color-coordinated carpeted floor mat  
-JAYCOMMAND® powered by Firefly (mobile app available)  
-High-intensity, recessed LED ceiling lights  
-High-gloss, polished porcelain floor tile with heated floor mat  
-Raised-panel high-gloss hardwood cabinetry and stiles throughout  
-Deluxe hidden cabinet hinges  
-Multi-functional legless dinette table  
-2-point lap safety belts in all designated seating locations  
-Dual 15,000-BTU A/C unit with heat pumps  
-Touchstone electric 5,000 BTU thermostat controlled fireplace  
-50 in. LED TV in living area (40 in. on 37K)  
-Sony Blu-Ray™ with HDMI connections  
-Cable TV hookup with RG-6 coax and video selector switch  
-Wood-framed kitchen window with spice cabinets  
-2-burner induction cooktop with LED display  
-Solid-surface kitchen countertop with large integrated stainless steel sink with sink covers  
-Water filtration system  
-One-piece, fiberglass shower with glass door, skylight and light  
-Porcelain toilet with foot flush  
-Solid-surface bathroom sink  
-Powered roof vent in bathroom with wall switch  
-Walk-around, King-sized bed with bedspread and nightstands  
-33" LED TV in bedroom  
-Large wardrobes  
-Smoke alarm  
-Carbon monoxide detector

**CUSTOMER VALUE PACKAGE**  
-JRIIDE® PREMIUM: Computer-balanced driveshaft, rear air suspension, heavy-duty rear stabilizer bar, full air brakes, SACHS shocks  
-Dual-pane, tinted, safety-glass windows  
-Roof-mounted Girard® NOVA II dual-pitched patio awning with LED lights  
-2,000-watt pure sine wave inverter  
-Power cord reel with 50-amp service  
-Aqua-Hot® 250D hydronic water and heating system  
-9" Sony® infotainment center with Apple CarPlay® and Android Auto™  
-Backup and side-view cameras  
-21-cu.ft. side-by-side residential refrigerator with ice and water in door  
-Flush-mounted convection microwave

### Optional Equipment

OPTIONAL EQUIPMENT INSTALLED ON THIS VEHICLE  
BY MANUFACTURER

|                          |            |
|--------------------------|------------|
| Base price               | 295,050.00 |
| Eggshell                 | n/c        |
| Stonewall Gray Cabinetry | n/c        |
| Grey Marvel Paint        | n/c        |
| USA Standards            | n/c        |
| Customer Value Package   | 11,250.00  |
| 21 FR S2RV 31000 279*    |            |
| 360 MXX3                 | n/c        |
| Washer/Dryer Combination | 1,800.00   |
| Trav'ler Direct TV       |            |
| Satellite Network        | 1,343.00   |
| Booth Dinette            | n/c        |
| Reclining Straight Sofa  | 593.00     |

UNIT TOTAL

310,036.00

DEALER INSTALLED OPTIONS<sup>1</sup>

## Manufacturer's Suggested Retail Price

\$310,036.00

TOTAL AMOUNT DOES NOT INCLUDE STATE AND LOCAL TAXES OR LICENSE FEES. THE PRICE SHOWN ABOVE MAY OR MAY NOT BE REPRESENTATIVE OF THE ACTUAL SELLING PRICE OF SIMILAR RECREATIONAL VEHICLES IN YOUR AREA.

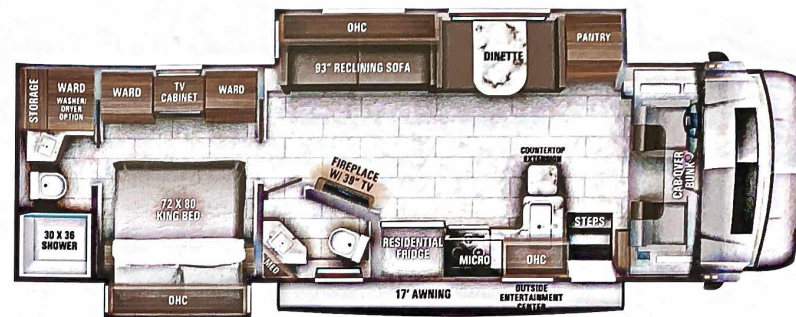

### DIMENSIONS

Exterior height:.....160.00"  
Exterior width:.....101.00"

### CAPACITIES

Fresh water tank (gals.):...72.00  
Gray water tank (gals.):...91.00  
Black water/toilet tank (gals.):...63.00  
Propane (lbs.):...83  
Propane (gals.):...19  
Water heater (gals.):...10.00

### TIRES

Tire size (front):.....275/80R22.5G  
Tire size (mid):.....  
Tire size (rear):.....275/80R22.5G

\*\*\*Some dimensions may be rounded and may vary from the actual dimensions\*\*\*

\*\*\*Weights may be estimated calculations and may vary from the actual weight  
- refer to the vehicle weight labels for actual weights\*\*\*

Floorplans, features and specifications are subject to change without notice.

**2+3**  
YEAR | YEAR  
LIMITED STRUCTURAL  
WARRANTY